



AVA S / AVA-DX RFC / RWC

EN OPERATION, INSTALLATION & MAINTENANCE INSTRUCTIONS



1. CONTENT

1. CONTENT	2
2. SYMBOLS AND MARKING	3
3. SAFETY INSTRUCTIONS AND PRECAUTIONS	3
4. INFORMATION ABOUT THE PRODUCT	4
4.1. DESCRIPTION	4
4.2. DIMENSIONS AND WEIGHT	4
5. INSTALLATION	8
5.1. RECEPTION OF GOODS	8
5.2. TRANSPORTATION AND STORAGE	8
5.3. UNPACKING	8
5.4. MOUNTING	8
6. MAINTENANCE	9
7. DECLARATION OF CONFORMITY	10
8. WARRANTY	11
8.1. LIMITED WARRANTY COUPON	11

2. SYMBOLS AND MARKING



Warning – pay attention



Additional information

Apply the technical label on the unit (in an easily accessible location) or on the dashed location of the technical manual to keep the important information about the unit.

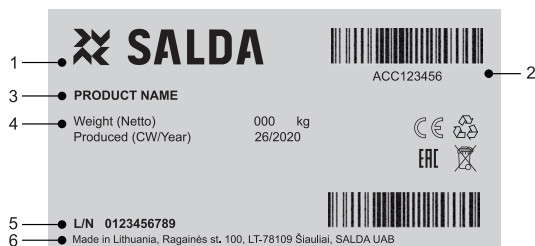

Figure 2.1. Technical label

1 - Logo; 2 - Product code (SKU); 3 - Product name; 4 - Technical data; 5 - Lot number; 6 - Production place.

3. SAFETY INSTRUCTIONS AND PRECAUTIONS

Read these instructions very carefully before installing and using this equipment. Installation, connection and maintenance should be carried out by a qualified technician and in accordance with local regulations and legislation.

The company shall take no responsibility for the injuries or damaged property if the safety requirements are not followed or the device is modified without the permission of the manufacturer.

Main safety rules

Warnings

- Do not use the unit for purposes other than its' intended use.
- Do not disassemble or modify the unit in any way.
- Never use this unit in any explosive or aggressive elements containing environment.
- Beware of sharp angles while carrying out installation and maintenance works.
- Do not touch heating elements until they haven't cooled down.
- Some devices are heavy, you should be very careful while transporting and installing them. Use suitable lifting equipment.
- Openings of the ducts should be covered during transportation and installation.
- Make sure not to damage the coil when connecting the piping of the water coil. For tightening up, use a wrench/spanner.



4. INFORMATION ABOUT THE PRODUCT

4.1. DESCRIPTION

Cooling coils are used for air cooling in ventilation systems. The coil consists of copper tubes and aluminium fins. The casing is made of galvanized sheet steel. Water type coolers use coolant - cold water. Freon type coolers use the R410A freon. Easy to mount. Suitable for operation indoor environment.

The purpose of the unit is: cooling of clean air. The unit is used in clean air ventilation and conditioning systems.



Not suitable for operation in pools, saunas and other similar premises.

4.2. DIMENSIONS AND WEIGHT

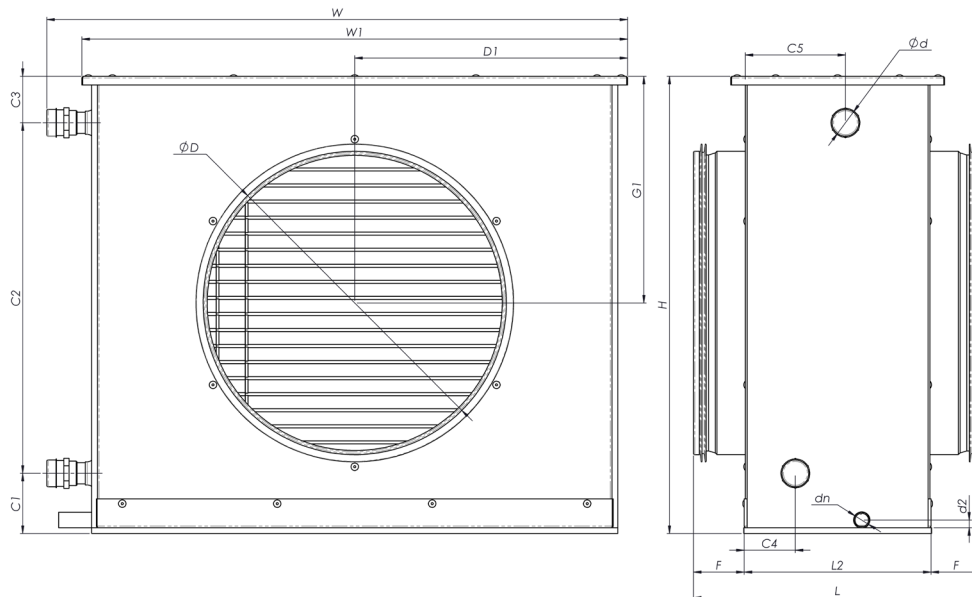

Figure 4.2.1. AVA S 100-500 dimensions

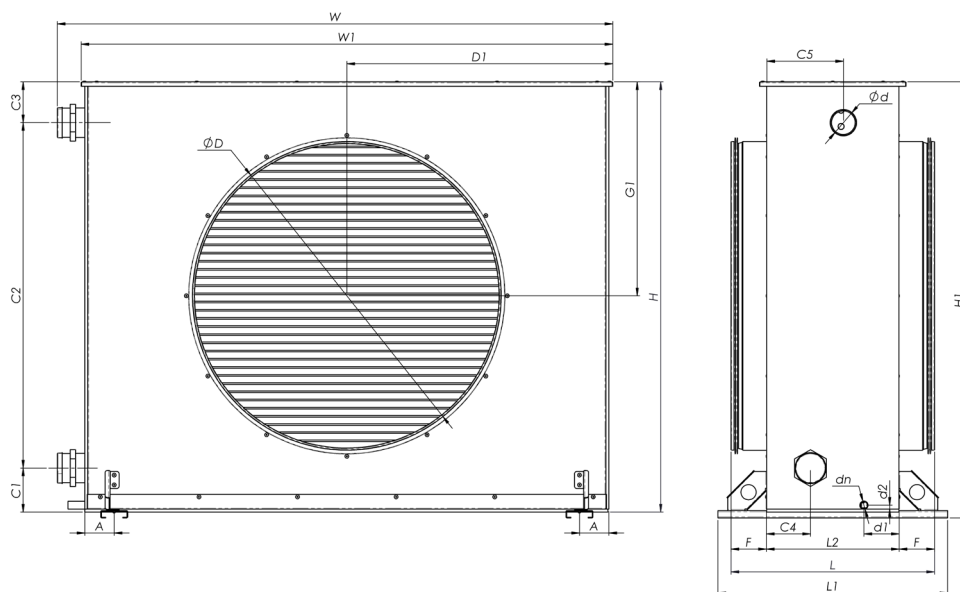

Figure 4.2.2. AVA S 600-710 dimensions

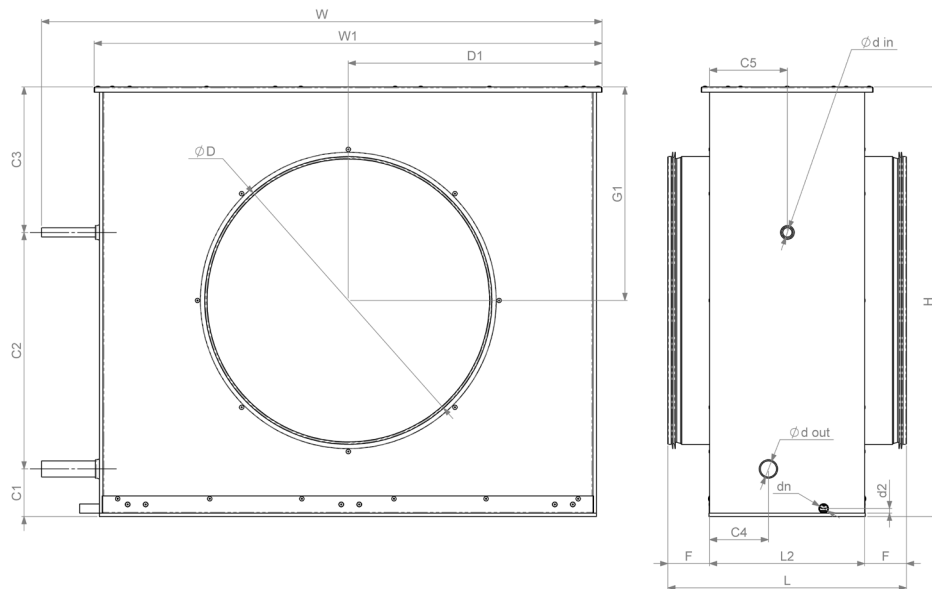

Figure 4.2.3. AVA-DX dimensions

		AVA S										AVA-DX			
		100	125	160	200	250	315	400	500	630	710	315	400	500	
L	[mm]	285				299			349	371	415	560	410	415	
W	[mm]	366			441	522	603	762	953	1 133	1 430	644	807	975	
H	[mm]	275			341	408	475		741	878	941	487	512	747	
ØD	[mm]	100	125	160	200	250	315	400	500	630	710	315	400	500	
L1	[mm]	-								469	544	-			
L2	[mm]	194						204	227	271	346	305	270	271	
Ød	[mm]	22						28	42	54		-			
dn	[mm]	16										16			
F	[mm]	46			53	54	74	72		107	53	73			
H1	[mm]	-								890	953	-			
A	[mm]	-								60	59	-			
C1	[mm]	53		119	159	63	114	73	89	88	60	75	83		
C2	[mm]	183		164	117	364	250	610	705	783	267	265	411		
C3	[mm]	38		58	131	48	111	58	81	70	160	172	253		
C4	[mm]	64		53	123	88		72	90	166	135	103			
C5	[mm]	91		104	70	52	58	130	156	227	199	135	150		
D1	[mm]	166		200	243	283	364	455	542	691	276	358	441		
Ødin	[mm]	-										12	16		
Ødout	[mm]	-										12	22	28	
G1	[mm]	135			202	235	229	368	435	468	242	253	371		
W1	[mm]	331		407	487	567	728	909	1 085	1 383	552	716	884		
d1	[mm]	72				71			72		-				
d2	[mm]	8				14			8		14	8			
Weight	[kg]	5,2		5,1	8	9,1	11,4	18	36	65	89	20	30	41	

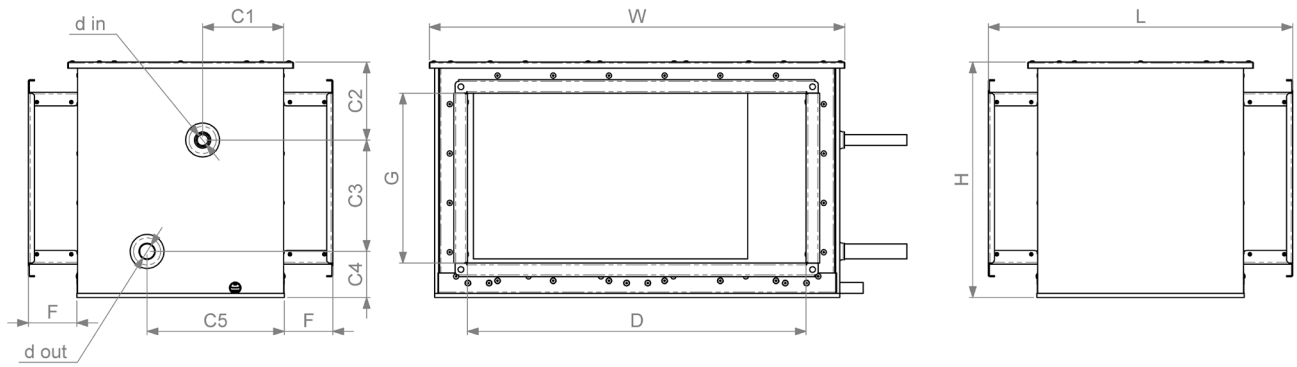

Figure 4.2.4. RFC dimensions

RFC		500x250 F2	500x250 F4	700x300 F2	700x300 F4	750x300 F2	750x300 F4	750x350 F2	750x350 F4
L	[mm]	450	449	450					
W	[mm]	615	614	813	791	924	841	890	
H	[mm]	346	347	400		390	397	446	
D	[mm]	500		700		750			
G	[mm]	250		300			350		
F	[mm]	70							
C1	[mm]	135	120	136	120		168	169	
C2	[mm]	56	115	65	137	134		114	
C3	[mm]	206	164	206	189			271	268
C4	[mm]	85	68	129	74			61	34
C5	[mm]	168	203	168	202			168	201
d in	[mm]	16		12	16				
d out	[mm]	22		12	22				29
Weight	[kg]	23	23	23	32	32	32	31	35

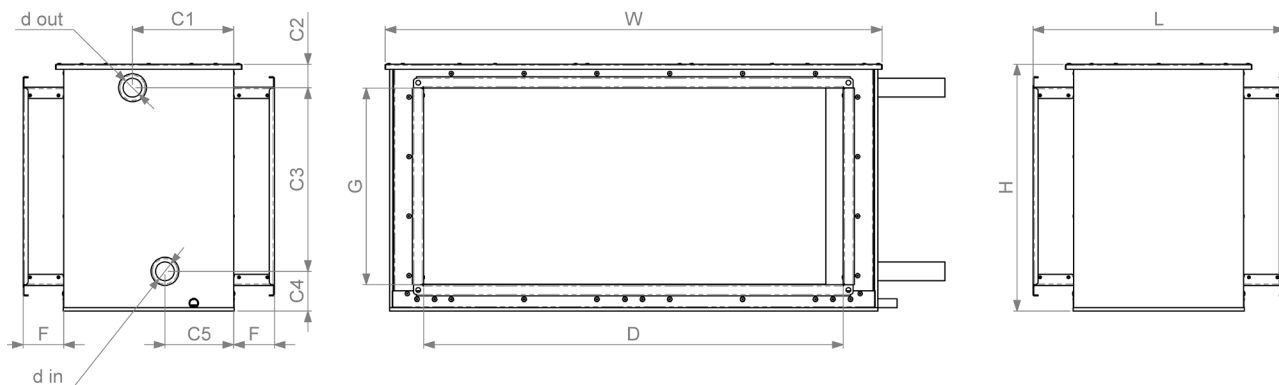

Figure 4.2.5. RWC dimensions

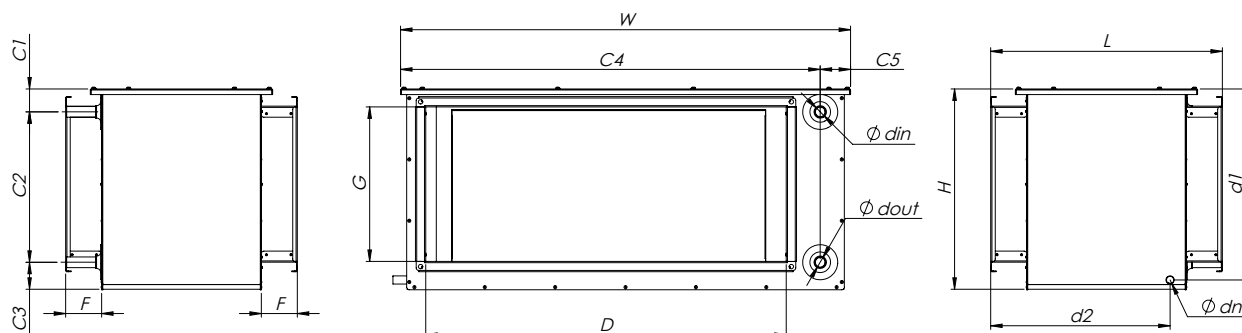

Figure 4.2.6. RWC 750x300 C4 dimensions

RWC		500x250 C2	500x250 C4	600x300	700x300 C4	750x300 C2	750x300 C4	750x350 C2	750x350 C4	1000x500
L	[mm]	450	449	449	450	449	450	450	415	
W	[mm]	615		700	791	854	924	888	1 156	
H	[mm]	347		540	400	405	390	440	640	
D	[mm]	500		600	700	750	750	750	1 000	
G	[mm]	250		300				350	500	
dn	[mm]	-				16		-		
F	[mm]	70		73	70	73	70	70	72	
C1	[mm]	167	196	165	172	167	48	181	163	
C2	[mm]	46		42	68	70	286	42	49	
C3	[mm]	233		247	261	267	56	327	513	
C4	[mm]	68		71	71	68	866	71	78	
C5	[mm]	138	109	123	133	138	57	123	106	
din	[mm]	26,7		33,4	33,4	26,7	26	33,4	48,3	
dout	[mm]	26,7		33,4	33,4	26,7	26	33,4	48,3	
d1	[mm]	-				371		-		
d2	[mm]	-				349		-		
Weight	[kg]	23		30	35	26	29	40	52	

5. INSTALLATION

5.1. RECEPTION OF GOODS

Each device is carefully checked before transportation. When receiving the goods, checking the devices for any damage made during transportation is recommended. If any damage to the unit is observed, immediately contact the representatives of a transport company. Please inform the representative of the manufacturer, if any deviation of the device is noticed.

5.2. TRANSPORTATION AND STORAGE

- All units are factory-packaged to withstand normal conditions of transportation.
- When unpacking, check the unit for any damage made during transportation. Installing the damaged units is not allowed!
- **The packaging is used for protection purposes only!**
- When unloading and storing the units, use suitable lifting equipment to avoid damage and injuries. The storage place must be protected against dirt and water.
- The recommended storage period should not be longer than one year.

5.3. UNPACKING

- Open the box.
- Take out the unit of the box.
- After unpacking the unit, examine it to make sure that no damage was made during transportation. Installation of damaged units is not allowed!
- Before commencing the installation of the unit, please check if all ordered equipment has been delivered. Any deviation from the ordered equipment list must be reported to the product supplier.

5.4. MOUNTING

Installing should only be performed by qualified and trained staff.

Coils are designed for mounting in horizontal position.

Water connection process should be processed using mounting scheme (see the scheme S1).

S1:

- a - water flow in;
- b - air flow;
- c - water flow out.

When cooler is already mounted the draining system has to be connected. In order to do that siphon must be screwed to the cooler draining exhaust.

The draining system should be filled up with at least 0,5 l of water (siphon must be always filled with water).

Check if water reaches sewerage system.

When installed, the cooler should have an angle of 0-3° (fig. S2).

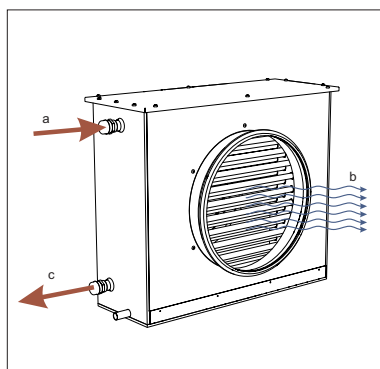

Figure 5.4.1. S1 - AVA S

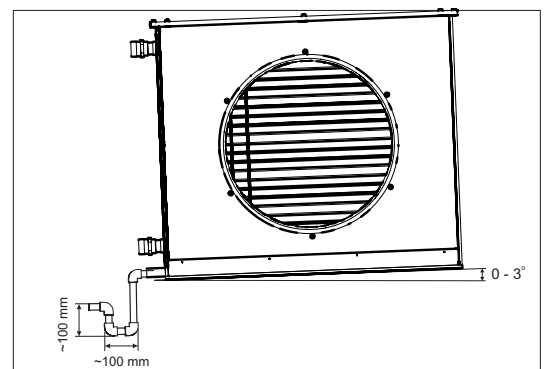

Figure 5.4.2. S2 - AVA S

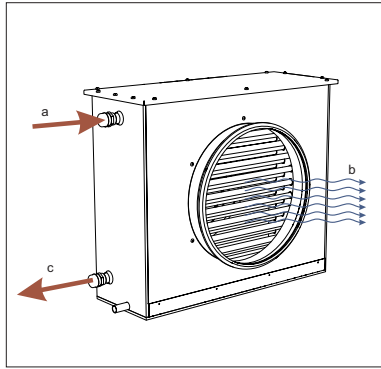

Figure 5.4.3. S1 - AVA DX

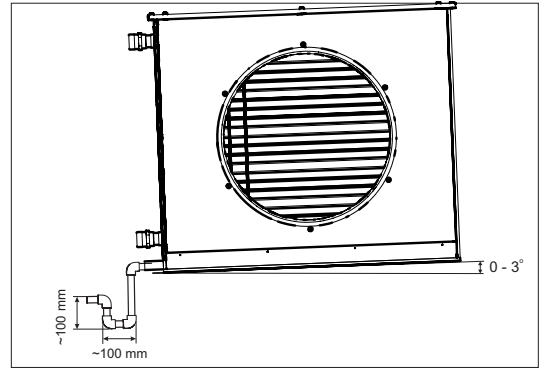

Figure 5.4.4. S2 - AVA DX

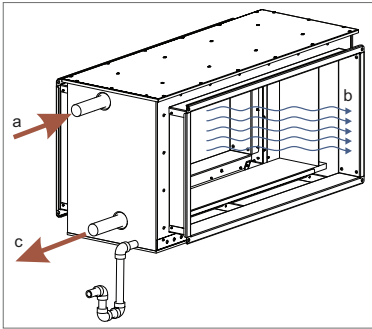

Figure 5.4.5. S1 - RFC

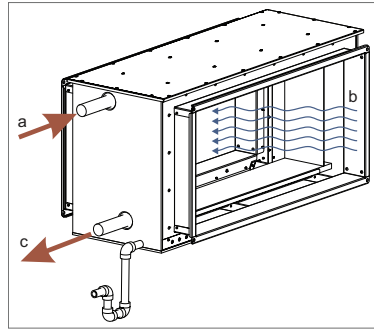

Figure 5.4.6. S1 - RWC

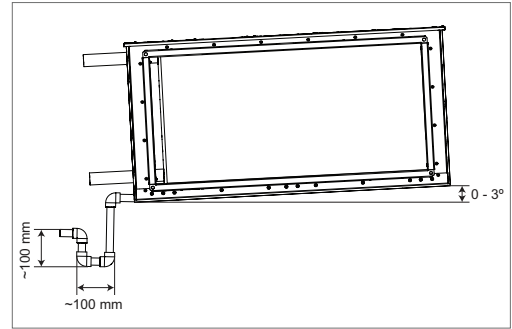

Figure 5.4.7. S2 - RWC/RFC

6. MAINTENANCE

In order to ensure proper functioning of the system, maintenance requirements and its periods should be observed. Otherwise, the warranty shall be void.

Maintenance shall be performed only by experienced and trained qualified personnel. During maintenance, it is recommended to check the proper operation of the product at regular intervals.

During the periodic inspection, make sure that:

1. There is no mechanical damage on the casing.
2. There is no coolant leak.
3. The system has proper pressure (it is especially important for freon type coolers).
4. There is no air in the system of the water cooler.
5. There is proper uninterrupted water circulation in the system of the water type cooler.
6. The air ducts are connected tightly, i.e. there are no cracks, tears, or other mechanical damage that may cause leakage in the system.

Cleaning

If cooler is soiled it should be cleaned.

1. Detach unit from ventilation and water supply systems.
2. Coil can be cleaned using tepid water and alkaline mixture which does not generate corrosion on aluminium.

7. DECLARATION OF CONFORMITY

Manufacturer

SALDA, UAB
Ragainės g. 100
LT-78109 Šiauliai, Lithuania
Tel.: +370 41 540415
www.salda.lt

Hereby confirms that the following products - Duct coolers:

AVA S* / AVA DX* / RWC* / RFC*

(where by „*“ indicates possible unit design size and modification)

Provided it was delivered and installed in the facility in accordance with the included installation instructions, comply with all applicable requirements in the following directives:

Machinery Directive 2006/42/EC
Pressure Equipment Directive 2014/68/EU

The following harmonized standards are applied in applicable parts:

LST EN ISO 12100:2011 - Safety of machinery - General principles for design - Risk assessment and risk reduction.
LST EN 378-2:2017 - Refrigerating systems and heat pumps - Safety and environmental requirements - Part 2: Design, construction, testing, marking and documentation.

Should any alterations be made in the products, this declaration will no longer apply.

Quality: Salda UAB activities are in line with the international quality management system standard **ISO 9001:2015**.

Date 2025-02-19



Giedrius Taujenis
Product manager

8. WARRANTY

1. All equipment manufactured in our factory is checked in operating conditions and tested before delivery. The test protocol is supplied together with the unit. The equipment is shipped in good working condition to the end client. The unit is warranted for the period of two years from the date of the invoice.
2. If equipment is found to have been damaged during transportation, a claim should be made against the carrier, as we assume no responsibility for such damage.
3. This warranty does not apply:
 - 3.1. when transportation, storage, installation and maintenance instructions of the unit are violated;
 - 3.2. when the equipment is improperly maintained, mounted - inadequate maintenance;
 - 3.3. when the equipment without our knowledge and permission has been upgraded or unskilled repairs were made;
 - 3.4. when the unit was used not for its original purpose.
 - 3.5. Company SALDA UAB is not responsible for potential loss of property or personal injury in cases where the Air Handling unit is manufactured without the control system and the control system is installed by the client or the third parties. The manufacturer's warranty does not cover devices that will be damaged by installing the control system.
4. This warranty does not apply to these malfunction cases:
 - 4.1. mechanical damage;
 - 4.2. damage caused by entering outside objects, materials and liquids;
 - 4.3. damage caused by natural disasters, accidents (voltage change in the electricity network, lightning, etc.).
5. The company assumes no liability for the damage to its products neither directly nor indirectly, if the damage is caused by failure to comply with the installation and mounting regulations, deliberate or careless users or third-party behaviour.

These conditions are readily discernible when the equipment is returned to our factory for inspection. If the direct client determines that equipment is found to be faulty, or a breakdown occurred, he should inform the manufacturer within five working days and deliver the equipment to the manufacturer. Delivery costs should be covered by the customer.



The manufacturer reserves the right to change this technical passport at any time without prior notice if some typographic errors or inaccurate information is found, as well as after improving the apps and/or the devices. Such changes will be included in the new issues of the technical passport. All illustrations are just for information and thus may differ from the original device. The newest manual version is available at <https://select.salda.lt>

8.1. LIMITED WARRANTY COUPON

Warranty term
24 months*

I received the complete package and technical manual of the product ready for usage. I have read the warranty terms and conditions and agree with them:

.....
 Customer's signature

*Refer to WARRANTY CONDITIONS

Dear User, we appreciate your choice and do hereby guarantee that all ventilation equipment manufactured by our Company is inspected and thoroughly tested. An operational and high-quality product is sold to the direct buyer and shipped from the territory of the factory. It is provided with a 24-month warranty from the issue date of the invoice. Your opinion is important to us, thus we always look forward to hearing your comments, feedback, or suggestions regarding technical and operational characteristics of the Products. In order to avoid any misunderstandings, please read the instructions for installation and operation of the product as well as other technical documents of the product carefully. The number of the Limited Warranty Coupon and the serial number of the product specified on the silver identification sticker attached to the housing must match. The Limited Warranty Coupon shall be valid provided that the seller's stamps and records are clear. It is not allowed to change, delete, or rewrite the data specified on it in any manner – such a coupon shall be invalid. With this Limited Warranty Coupon the manufacturer confirms his obligations to implement the imperative requirements established by effective laws on protection of consumer rights in the event of identification of any defects of the products. The manufacturer reserves the right to refuse provision of free warranty servicing in cases when the warranty conditions listed below are disregarded.

PRODUCT MAINTENANCE TABLE

Product name*

lot number*

* - Look at the product label.



NOTE. The customer shall be required to complete the Product Maintenance Table.

MANUALS IN OTHER LANGUAGES

DE



<https://select.salda.lt/file/ava-s-ava-dx-rfc-rwc-new-de>

FR



<https://select.salda.lt/file/ava-s-ava-dx-rfc-rwc-new-fr>

IT



<https://select.salda.lt/file/ava-s-ava-dx-rfc-rwc-new-it>

LT



<https://select.salda.lt/file/ava-s-ava-dx-rfc-rwc-new-lt>

RU



<https://select.salda.lt/file/ava-s-ava-dx-rfc-rwc-new-ru>



MAN000567

